

R11 MANUAL RESET RELAY



www.k-dyne.com

702 South Persimmon, Suite 1C
Tomball, TX 77375
P: 281.397.7099
F: 281.397.7495

MODEL R11 MANUAL RESET RELAY

The K-Dyne Model R11 pneumatic relay is a compact manually operated instrument valve that is well suited for the rigors of inland and offshore production control systems. It operates as a 3-way normally closed, manual reset pneumatic valve with a detent (BYPASS) feature. Its construction makes it ideal for field mounting on actuators, pressure sensors or other control devices.

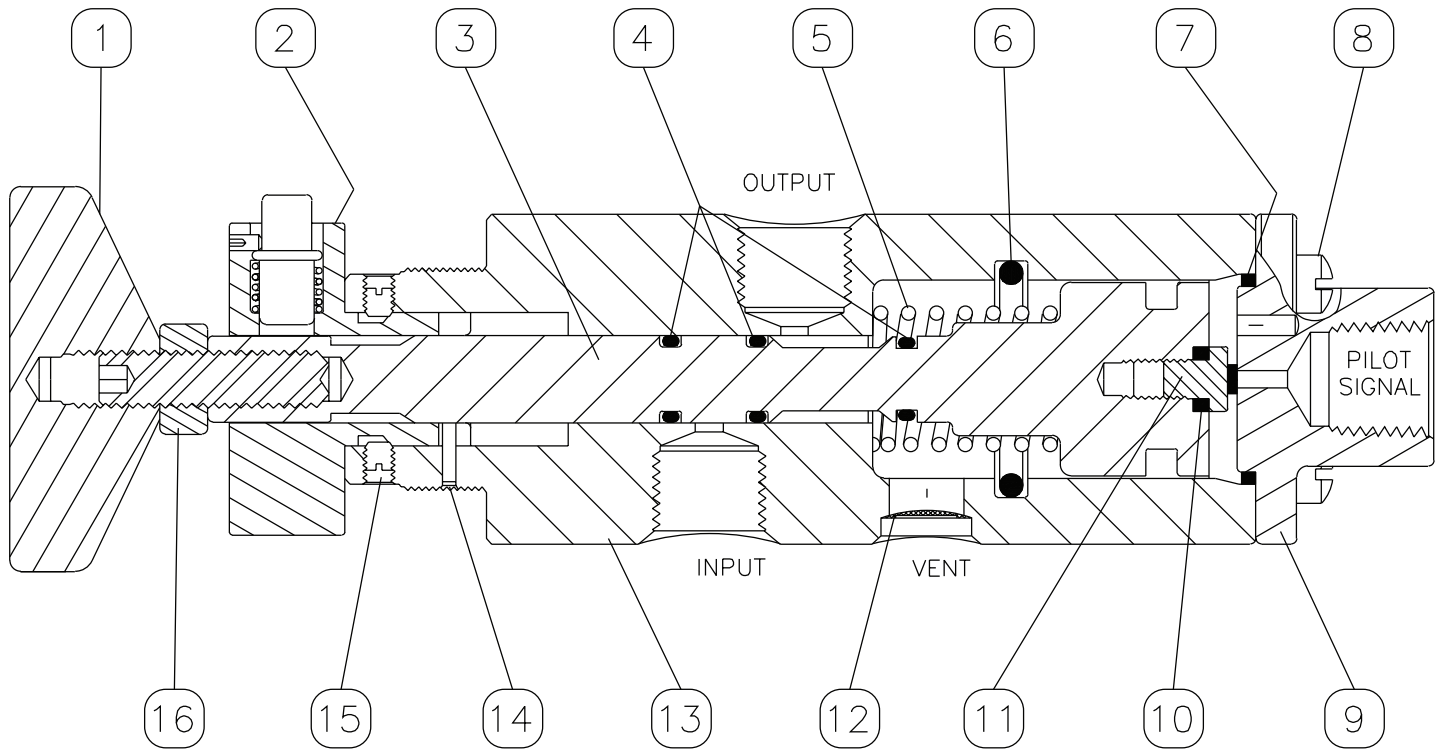

Parts List for R11 Manual Relay

ITEM NO.	QTY.	DESCRIPTION	MATERIAL	PART NO.
1	1	Knob	Delrin 507	10-014-000
2	1	Detent Assembly	Delrin 507 (housing), AISI 316 (pin) & AISI 316 (spring)	10-017-000
3	1	Shaft Assembly	AISI 316 St. Stl. & 18-8 Set Screw	11-009-0A0
4	3	Shaft O-Ring	Flourocarbon	V0-009-75T
5	1	Spring	Inconel X-750	10-010-000
6	1	Body O-Ring	Flourocarbon	V0-119-75T
7	1	Base O-Ring	Flourocarbon	V0-019-75H
8	4	Fillister Screw	18-8 St. Stl.	TP-832-0C4
9	2	Base	AISI 316 St. Stl.	11-002-000
10	1	Poppet O-Ring	Flourovarbon	V0-006-75H
11	1	Poppet Assembly	18-8 St. Stl. & Flourocarbon	11-004-000
12	1	Screen	AISI 304 St. Stl.	11-010-000
13	1	Body	AISI 316 St. Stl.	11-003-000
14	1	Guide Pin	AISI 302 St. Stl.	R2-002-008
15	2	Set Screw	Nylon	T4-632-045
16	1	Hex Nut	AISI 316 St. Stl.	T6-08K-073
17	---	Repair Kit	Items 4,6,7,10,11,12 & 15	11-005-000

FEATURES

- Compact size saves space in panel use
- Panel mountable using optional nut
- Integral screen on "VENT" port
- Field proven materials for construction
- Latch closed design prevents pilot signal from opening relay
- Detent pin for temporary "BYPASS"

SPECIFICATIONS

Supply Pressure	Vacuum to 150 psi (10.3 Bar)
Pilot Signal Pressure	25 psi (1.7 Bar) to open 20 psi (1.3 Bar) to close
Operating Temperature	-20/+180° F -29/+82° C
Cv Factor	.34

Ordering Number **R11-K10M2V000**